



CENTRAL RIFT VALLEY WATER WORKS DEVELOPMENT AGENCY

CONSTRUCTION WORKS FOR MASAANTARE WATER PAN

TENDER NO. CRVWDA/NAR/MAS/WP/GOK/36/2023-2024

ADDENDUM NO. 1

February, 2024

Pursuant to Section (75) of the PPADA (2015) which states that (1) “A procuring entity may amend the tender documents at any time before the deadline for submitting tenders by issuing an addendum without materially altering the substance of the original tender” and that the (2) amendment may be made on the procuring entity's own initiative or in response to an inquiry by a candidate or tenderer.

We hereby make amendments to the bid document issued as follows and this is referred as addendum No. 1

Ref No.	Requirements & Clauses In The Bid Document Or Act And Regulation	Amendment on the tender Document or response to the requirements
1	Clause 21.1 In the Instruction to Bidders, the Tender Data Sheet amended requiring the bidders to submit a Tender-Securing Declaration Form	The Tenderer shall furnish as part of its Tender a tender security in form of <u>BANK GUARANTEE</u> of Ksh 250,000 Valid for 150 days. The requirement for Tender-Securing Declaration form is hereby waived.
2	Publishing the tender Notice in the Public Procurement Information Portal in line with Section 96 of the PPADA (2015)	In addition to the Invitation to tender Notice Published in the Dailies, bidders can obtain the Invitation to tender notices at the PPIP portal and the Agency's Website https://tenders.crvwwda.go.ke/
3	The requirement for provision of drawings in line with The Public Procurement And Asset Disposal Regulations, 2020 72(2)(b)	The Drawings are provided as follows. <ol style="list-style-type: none"> 1. <i>Cattle trough</i> 2. <i>Intake Tower</i> 3. <i>Spill way Typical Drawing</i> 4. <i>Layout Plan</i> 5. <i>Toilet Drawing</i>
4.	Extension of Bid Submission Deadline	As per the Notice Published in the Dailies and uploaded on the PPIP portal and the Agency's Website, the bid closing date is hereby extended to 20th February, 2024 at 12:00 PM, the opening of bids shall thereafter be carried out on 20th February, 2024 as from 12:05 PM

Issued with the Approval of:



for CPA. Douglas Murei
Ag. Chief Executive Officer.

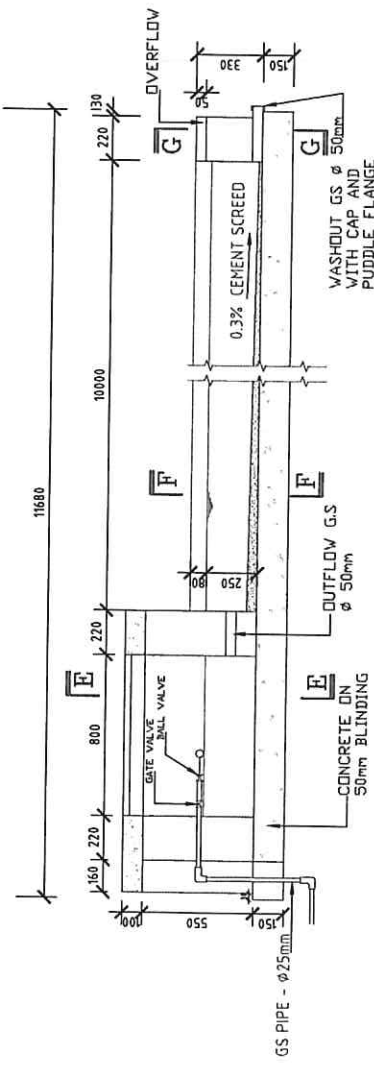
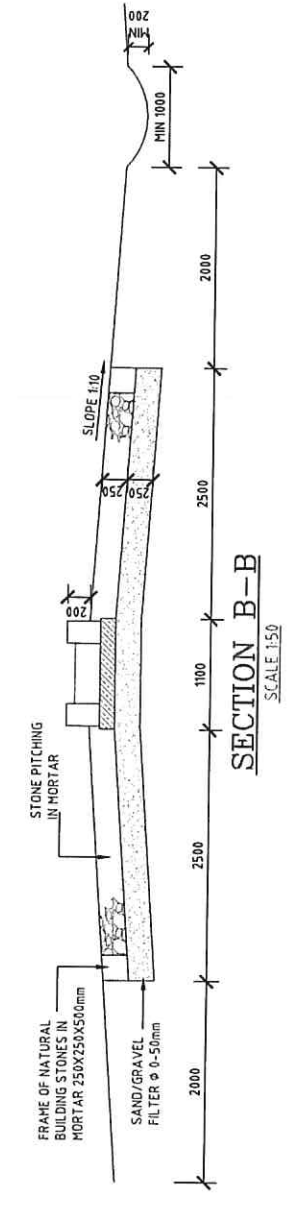
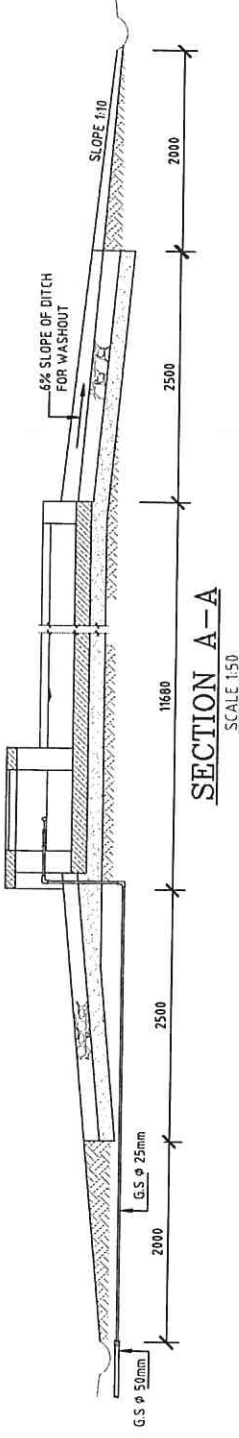
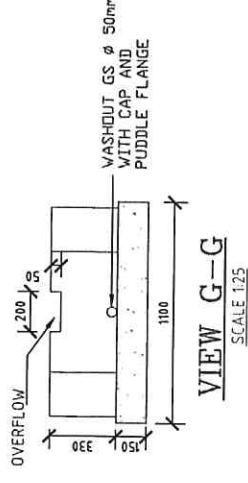
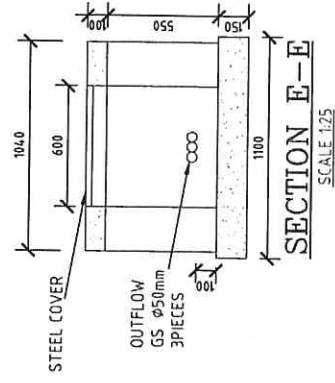
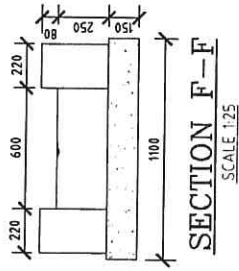

CENTRAL RIFT VALLEY WATER
WORKS DEVELOPMENT AGENCY

CATTLE TROUGH

DESIGNED	K.K & D.N	2023	SHEET 1 OF 1
DRAWN	K.K & D.N	2023	SCALE: AS SHOWN
DIGITIZED	K.K & D.N	2023	DRG. NO.
CHECKED	L.M	2023	CRVW/DA
APPROVED	J.M.S	2023	01B-TYPE-026A

GENERAL NOTES

1. All dimensions are in millimetres unless otherwise stated.
2. Only figured dimensions to be taken.
3. Drawing not drawn to Scale.
4. Reinforcement cover, (a) Slab 25mm
5. Concrete class 15/20 for blinding.
6. B2-Drop inlet structure.
7. B1-Drop outlet structure.



PROJECT TITLE

TYPICAL DRAWING

DRAWING TITLE

PLAN & SECTIONS OF THE INTAKE STRUCTURE

NAME	DATE
DRAWN BY K.K. & D.S.	NOV. 2023
DESIGNED BY K.K. & D.S.	NOV. 2023
CHECKED BY J.S.	NOV. 2023

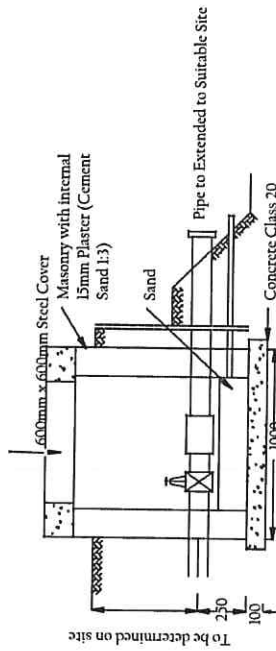

SECTION A-A

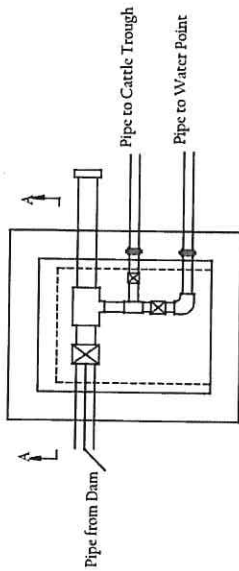

PLAN

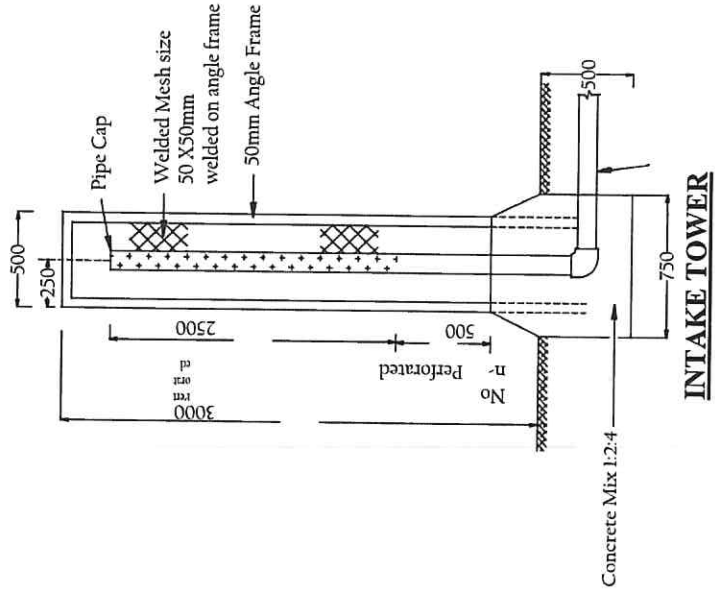

INTAKE TOWER

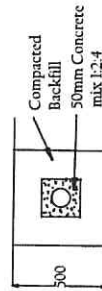

PIPE TRENCH

X-X2 PROFILE

884 884

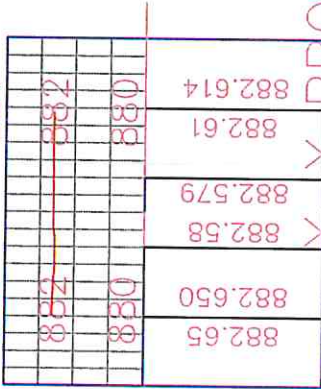

X-X PROFILE

884 884



Y-Y PROFILE

884 884

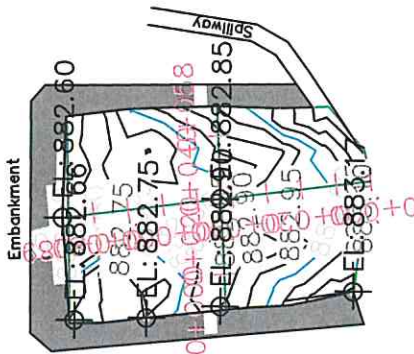
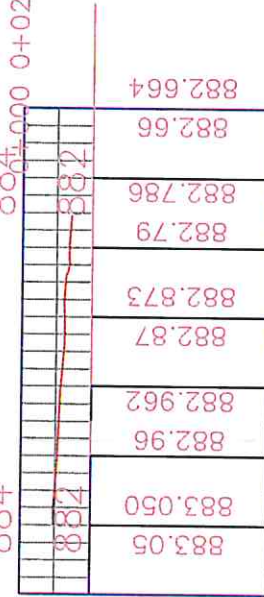

CLIENT

THE GOVERNMENT OF KENYA
THROUGH
CENTRAL RIFT VALLEY WATER WORKS DEVELOPMENT AGENCY
P.O BOX 2451-20100
NAKURU

c:\Users\Victor\Documents\Project\Logo.jpg

PROJECT TITLE

PROJECT NAME: PROPOSED MASHANTARE WATER PAN
LOCATION: MARK SOUTH SUB-COUNTY
CAPACITY: 20,000 CU
DESIGN DEPTH: 2.4M

NOTES

- All dimensions are in m unless otherwise
- All dimensions to be read off and not scaled

SURVEYED BY: KOSBO
DRAWN BY: HURDANT
DESIGNED BY: HURDANT
CHECKED BY: Lury Mburu
APPROVED BY: Joseph Soka

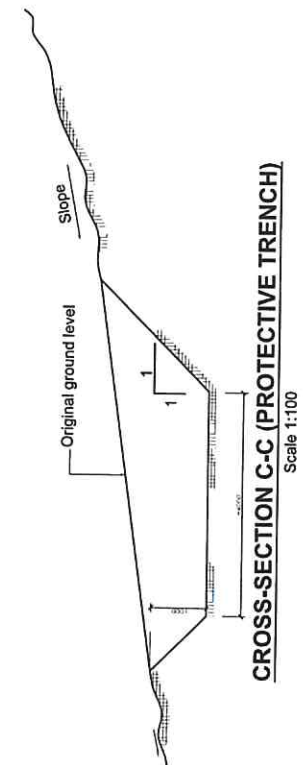
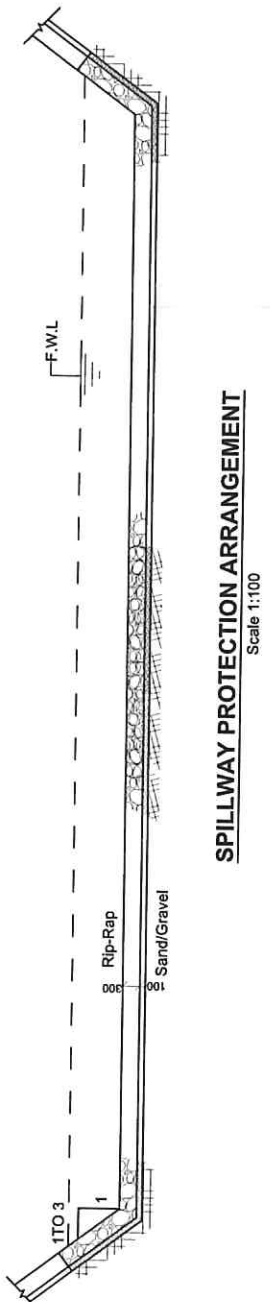
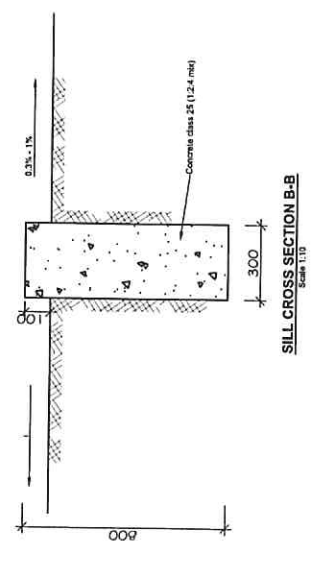
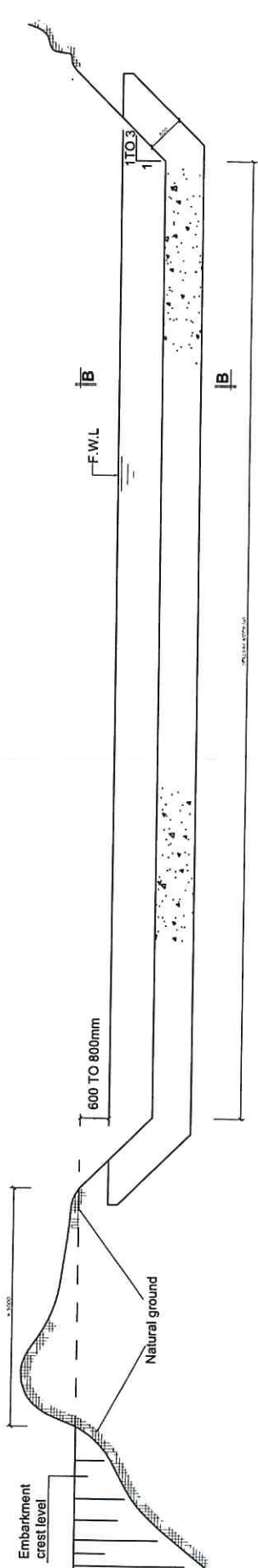



**CENTRAL RIFT VALLEY WATER
WORKS DEVELOPMENT
AGENCY**

TYPE DRAWING	
DESIGNED	K.K & D.N 2023
DRAWN BY	K.K & D.N 2023
CHECKED	L.M 2023
APPROVED	J.M.S 2023

SHEET 1 OF 1

SCALE: AS SHOWN

CRVWMDA

SPILLWAY FOR SMALL EARTH DAMS

SANITARY FACILITIES

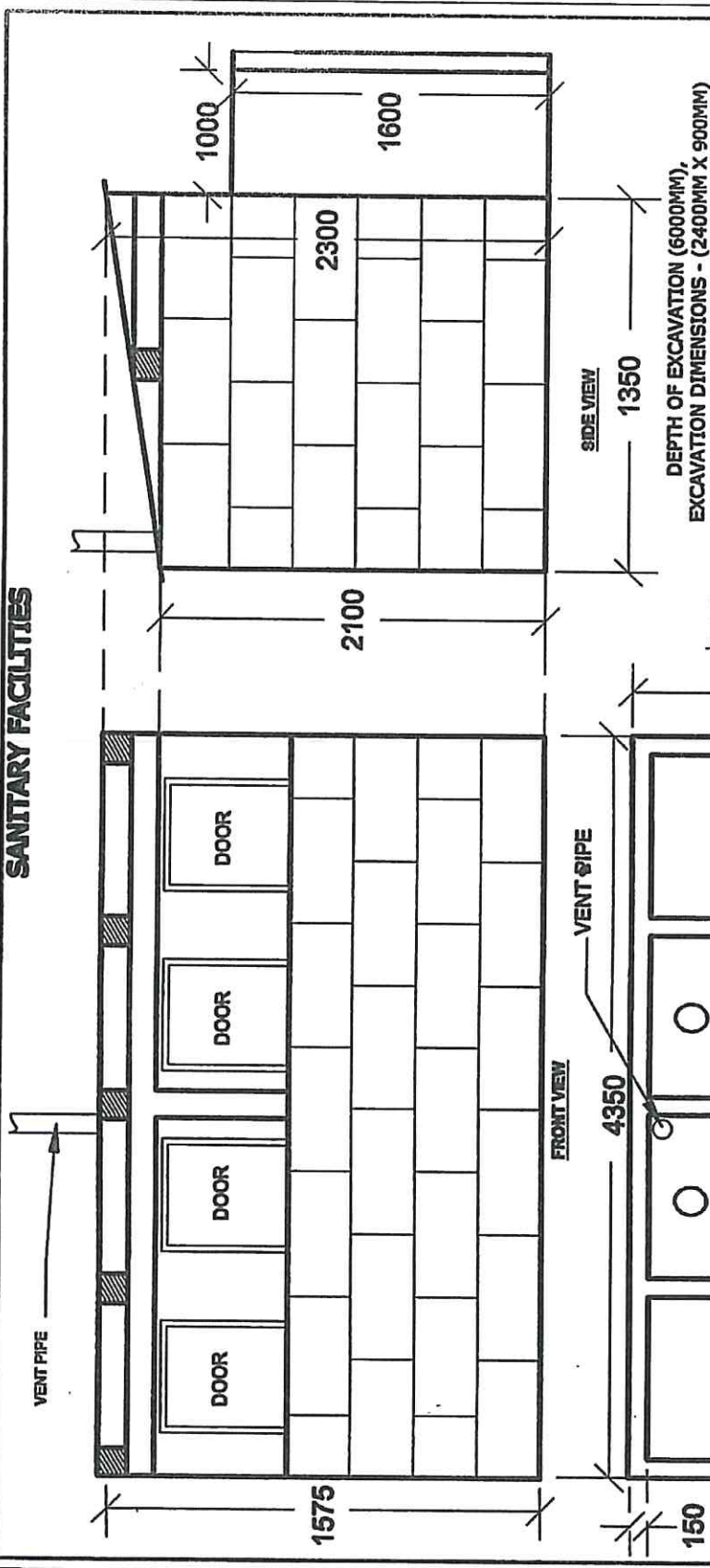

WASHROOMS

Drawing Type	Typical Drawing
Designed	K.K
Digitized	K.K
Checked	L. MBURU
Approved	J.SALEE

DEPTH OF EXCAVATION (6000MM),
EXCAVATION DIMENSIONS - (2400MM X 900MM)

scale 1:1200

All units mm

